

# DCR-Services

## Data Centre Compliance Review

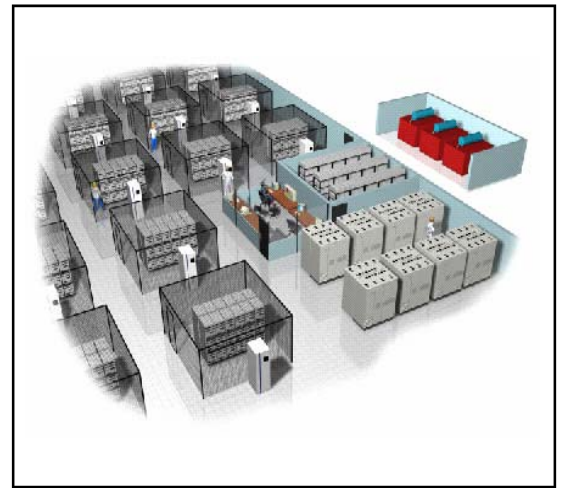

### Introduction

Today's Data Centre and Telecommunication sites are the backbone of the business. Downtime means frustrated customers and lost revenue and business opportunities.

It's therefore of utmost importance for companies to audit the data centre to discover (potential) risk factors which could lead to downtime before it is too late.

Standards such as BASEL-II require risk analysis of the infrastructure, including the data centre. BC/DR/BCM plans normally include an evaluation of the business risk and vulnerability of the infrastructure both in the production data centre as well as the recovery site.

By having an in-depth understanding of the (potential) risks in your data centre or telecommunication site, you are able to prioritize investments for improvement in line with the risks in different areas.

### Data Centre Compliance Review

A seasoned data centre auditor will review the data centre design concept and whether it would be able to serve the uptime required by the business.

The audit reviews the following fundamentals of the datacenter:

- Data centre location and general construction
- Electrical layout and dimensioning
- Environmental control and monitoring
- Fire Suppression
- Electromagnetic Fields (EMF)
- Network
- Operational Security and safety
- Maintenance and Support

About half a day will be spent reviewing design plans, electrical single line diagrams, fire suppression and cooling design and capacity calculations, cable routings, maintenance contracts, service reports etc.

The other half of the day will be used to conduct an in-depth physical inspection of the data centre and its supporting facilities (i.e. gen-set, ups room etc.) with some measurements taken to complete the risk analysis.

**Do you know the (potential) risks in your Data Centre which could lead to downtime?**

**Does your Data Centre comply to international recognized norms and standards?**

### Main Features of DCR:

- Audit of the Data Centre construction, electrical layout and dimensioning, environmental monitoring and control, fire suppression, EMF, Security and Safety, Maintenance and support arrangements
- Report with findings, risk analysis and possible solutions for improvements which will lead to mineralization of risks and therefore improved hi-availability.

### Main Benefits:

- Clear analysis of risk areas in the datacenter that could lead to costly downtime
- Allows for proper investment planning for future enhancements
- Reduces risks of downtime via pro-active measures
- Allows you to highlight to contractors and maintenance/service organizations to rectify their work and/or improve their service levels
- Report provides input to BC/DR/BCM plans and for standards such as BASEL-II
- Prepare datacenter for Certification under the DCC program

## Reporting

The output of the audit will be a concise report which will highlight the findings, gaps versus various international standards such as IEC, Ashrae, IEEE etc., recommendations for improvement and constructive information on how to reduce the risks in the data centre which could lead to downtime

The report will be delivered online (PDF format), typically within 5 days after the audit.

## Where to use DCR?

The DCR service can be of help in many situations:

### New Data Centre's

DCR could be conducted after your new data centre has been built in order to evaluate the design and implementation works provided by the contractor or data centre builder. In some cases the data centre is not built up to the mark due to oversight of the workers or even to the extend of contractors trying to cut corners in order to increase their margins. DCR will find the design flaws and incomplete or sub-standard work enabling you to force the contractor to rectify and make good those areas before you pay your final invoice and move your mission critical equipment in production. Rectifying problems whilst running production can prove to be costly and disruptive so better be safe than sorry.

### Existing Data Centre's

DCR could add tremendous value to existing data centre's which have been running for one or more years. Some of these data centre's are inherited by you and you might not always be aware of the (hidden) risks that could lead to downtime. Data centre's are dynamic places and are exposed to constant change in which maybe not all of the risks are properly identified leaving the investments made redundant. Simple changes such as running new network cabling could mean a contractor makes a hole in the wall under the floor and not closing it reducing the effectiveness of your costly fire suppression system maybe even to the point of not working at all when you really need it...

DCR will find the risks before it is too late.

## Business Continuity Management

BC/DR/BCM contain risk management evaluation mostly as part of the BIA (Business Impact Assessment) reports. Most of the business continuity consultants are more familiar with business process risk analysis rather than mission critical facilities. DCR could be an essential part in evaluating the risks in the data centre itself and the recovery site to a much greater level of details than most business continuity consultants could do due to our experience in auditing mission critical facilities.

Without knowing your internal risks your BC/DR plans will never be truly complete and reflecting all the risks.

## Compliance to Standards (BASEL-II etc.)

In today's world more and more standards and norms are forced upon organizations ranging from governance to technical compliance. Some of these standards, for example BASEL-II, require analysis of the risk at the data centre level. DCR is able to give an extensive report detailing the risks.

## Customised audits

The DCR service offering can be customized to fit your needs. The standard DCR audit is comprehensive enough for most customers however, should you need to broaden the scope and/or depth in certain areas to be audited then this can be accommodated. Please feel free to discuss with us your specific needs.

Asia/Pacific Headquarters:  
**Enterprise Products Integration Pte Ltd**  
37th floor, Singapore Land Tower, 50 Raffles Place, Singapore 048623.  
Tel: + (65) 6733-5900 Fax: + (65) 6735-6400  
e-mail: sales@epi-ap.com <http://www.epi-ap.com>

Europe:  
**EPI Service Limited**  
Wilton Park, Avenue Two, Station Lane, Witney Oxfordshire OX8 6FH, United Kingdom.  
Tel: + (44) 01993-708855 Fax: + (44) 01993-708850  
e-mail: sales@epi-uk.com <http://www.epi-uk.com>

**EPI France**  
30 avenue de l'Amiral Lemonnier, 78160 Marly le Roi, France.  
Tel: + (33) 0 3917-1557 Fax: + (33) 0 3917-1558  
e-mail: sales@epi-fr.com

